



## TOYOTA HILUX 1KD 2012 M1 PLUG-IN ECU KIT INSTALL INSTRUCTIONS



**MoTeC**

### M1 Toyota Hilux 2012 1KD Kit Components:

1. MoTeC M130 ECU
2. MoTeC Toyota Hilux 1KD 2012 Adaptor Box
3. M5 x 20mm Button Head Cap Screws (Qty 3)
4. MoTeC Toyota Hilux 1KD 2012 Breakout Loom
5. M1 Adaptor 250mm Stub Loom D (Ethernet Cable)
6. M1 Adaptor 250mm Stub Loom C

**MoTeC****Tools required to install the kit:**

- Phillips Head Screwdriver
- 10mm Spanner
- 3mm Allen Key

**MoTeC****Step 1:**

Fit two stub looms to the Adaptor Box ensuring that the Ethernet port end is free to connect to the M1 ECU.

***MoTeC*****Step 2:**

Position the M130 ECU as shown and secure with three M5 x 20 button head screws.

**MoTeC****Step 3:**

Affix the breakout loom to the Adaptor Box.

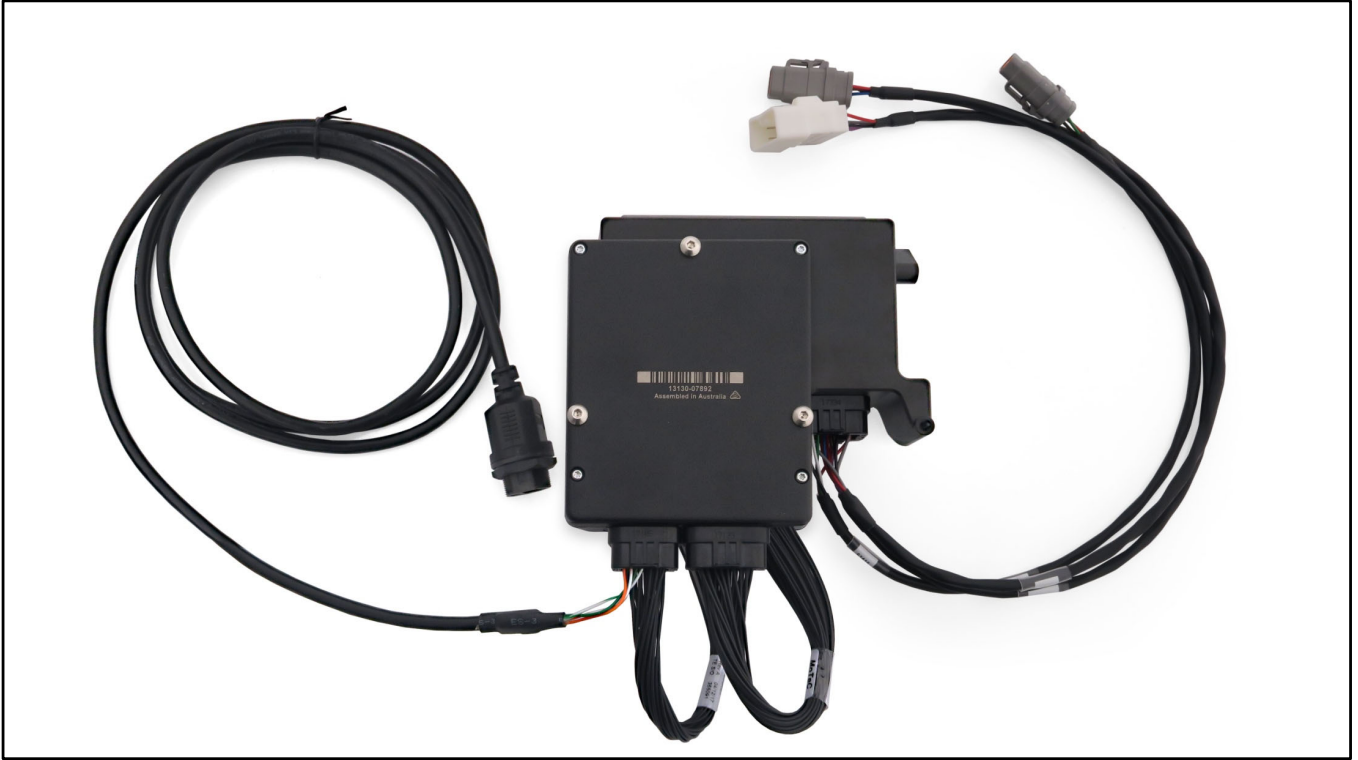
**MoTeC****Step 4:**

Connect the stub looms to the M1 ECU. The assembled kit looks like this.

**Step 5:**

Open the glove box and remove the entire assembly.

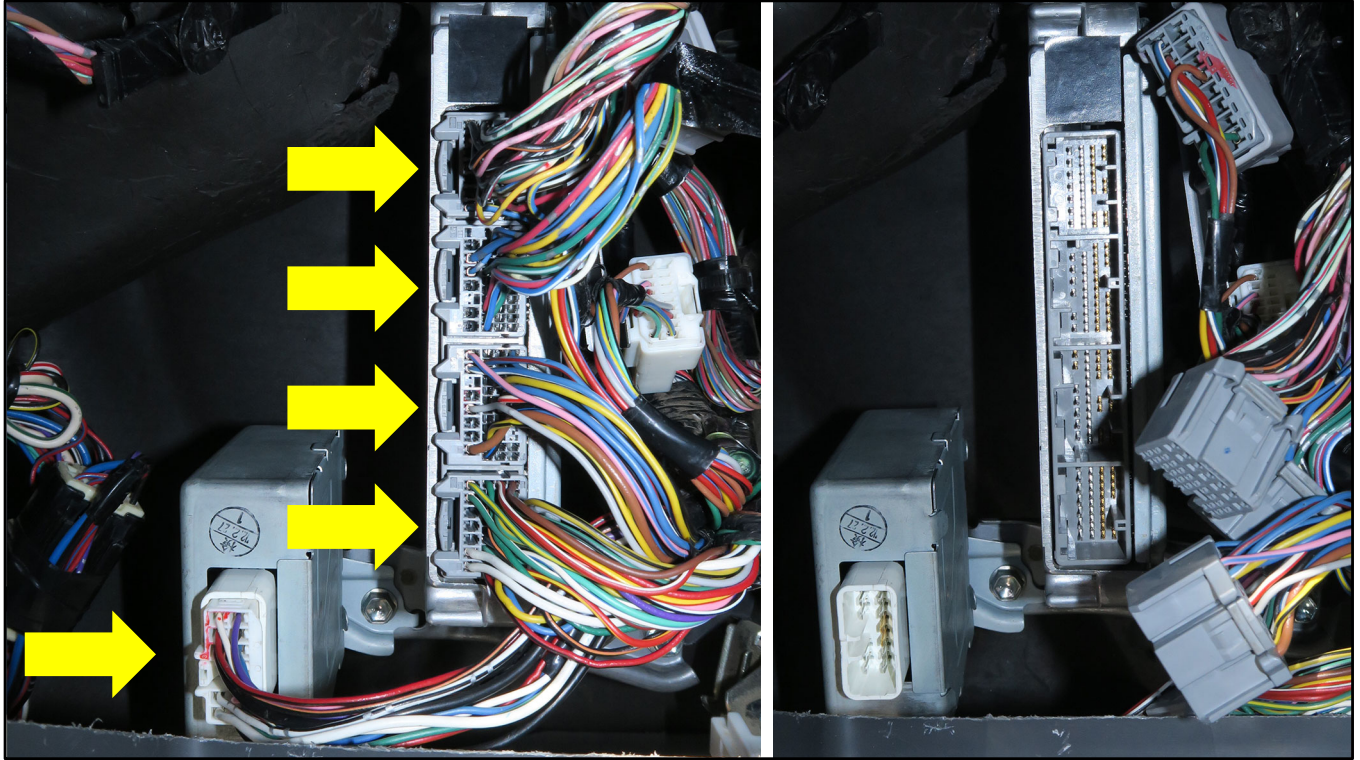

**MoTeC****Step 6:**

Disconnect the ECU and Turbo Control ECU connectors to allow for ECU removal.

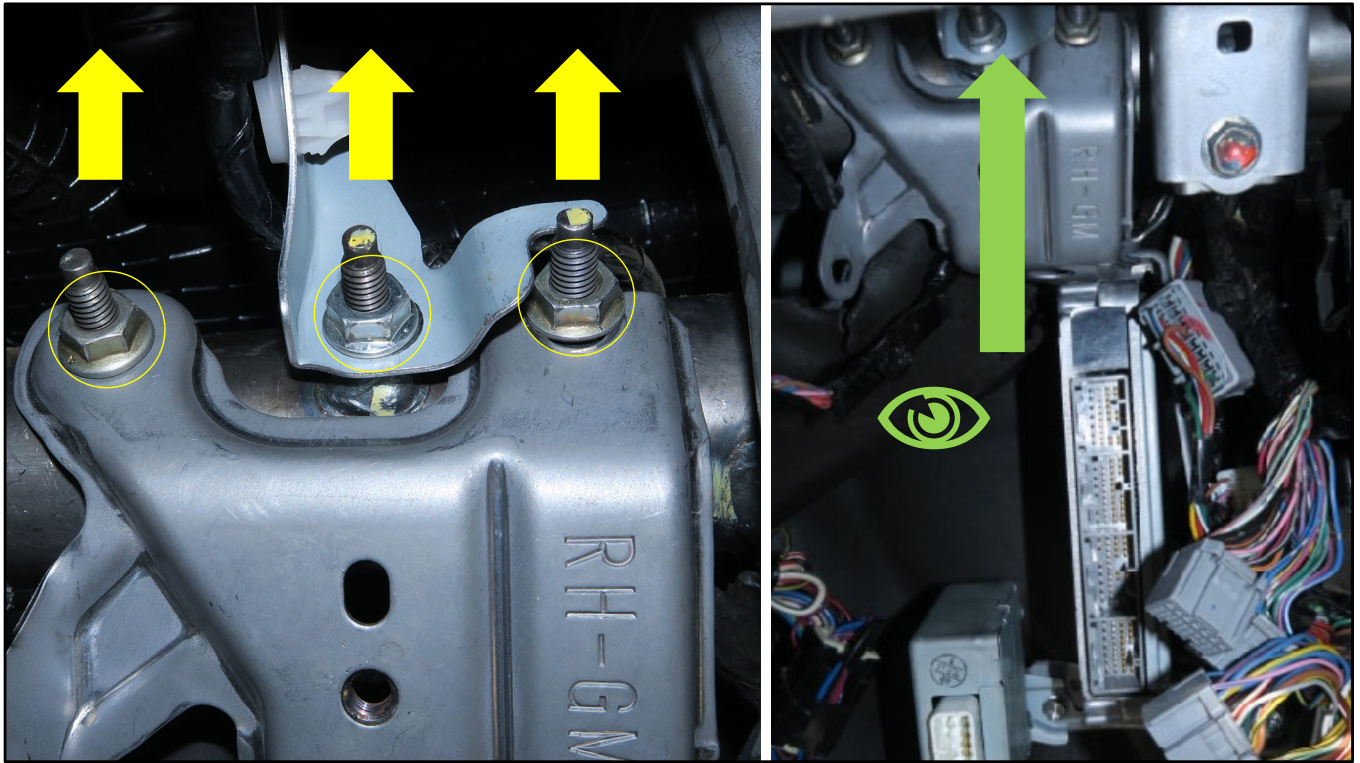
**MoTeC****Step 7:**

Remove the three nuts from the upper mounting bracket.

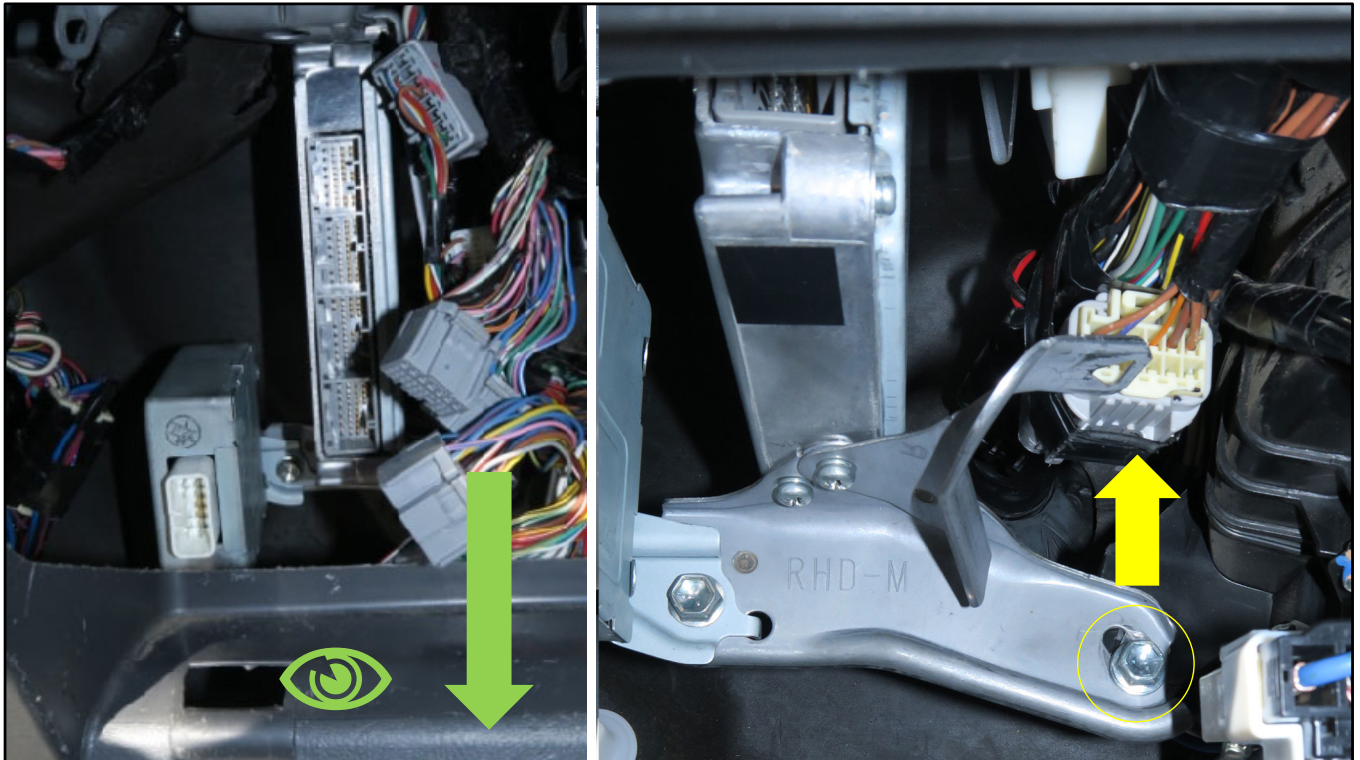
**MoTeC****Step 8:**

Remove one nut from the lower mounting bracket (accessed from the underside of the glove box).

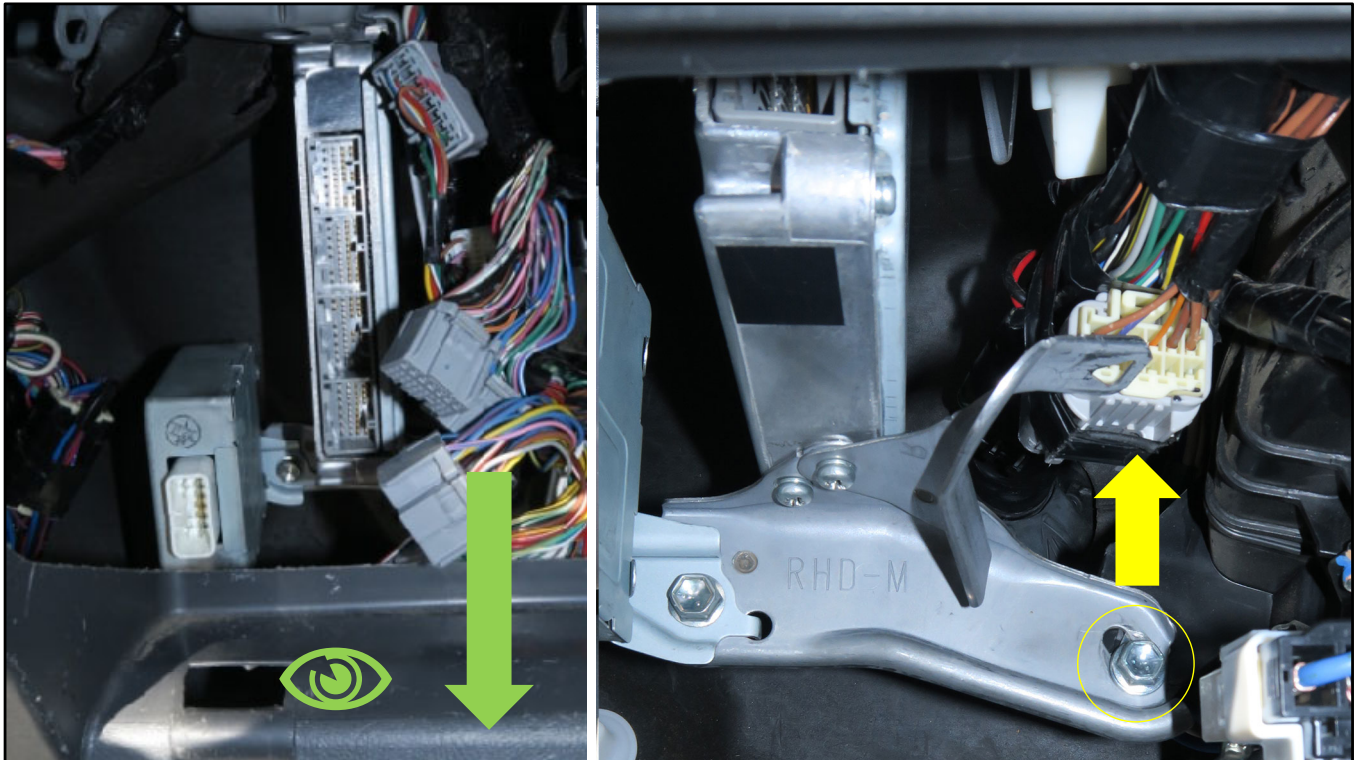

**MoTeC****Step 8:**

Remove one nut from the lower mounting bracket (accessed from the underside of the glove box).

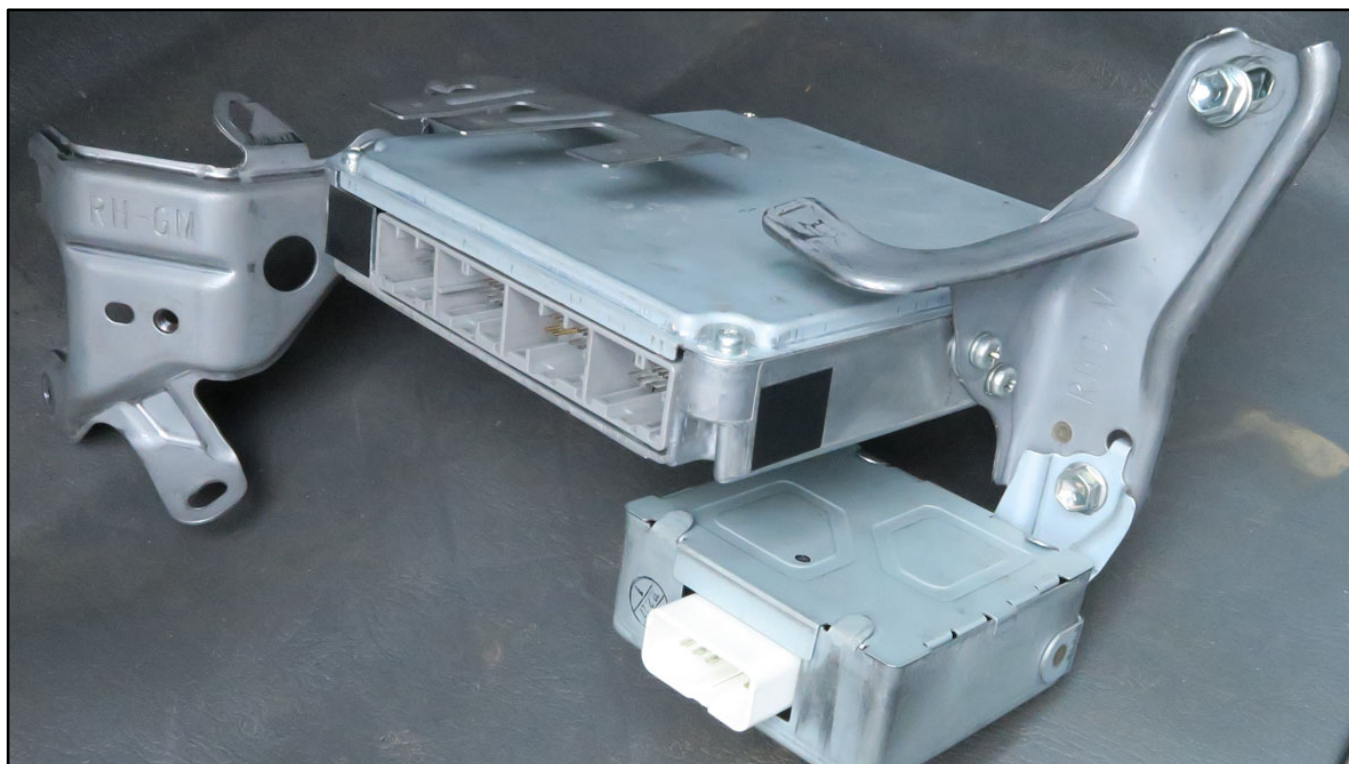
**Step 9:**

Remove the assembly of ECU, Turbo Control ECU and brackets.

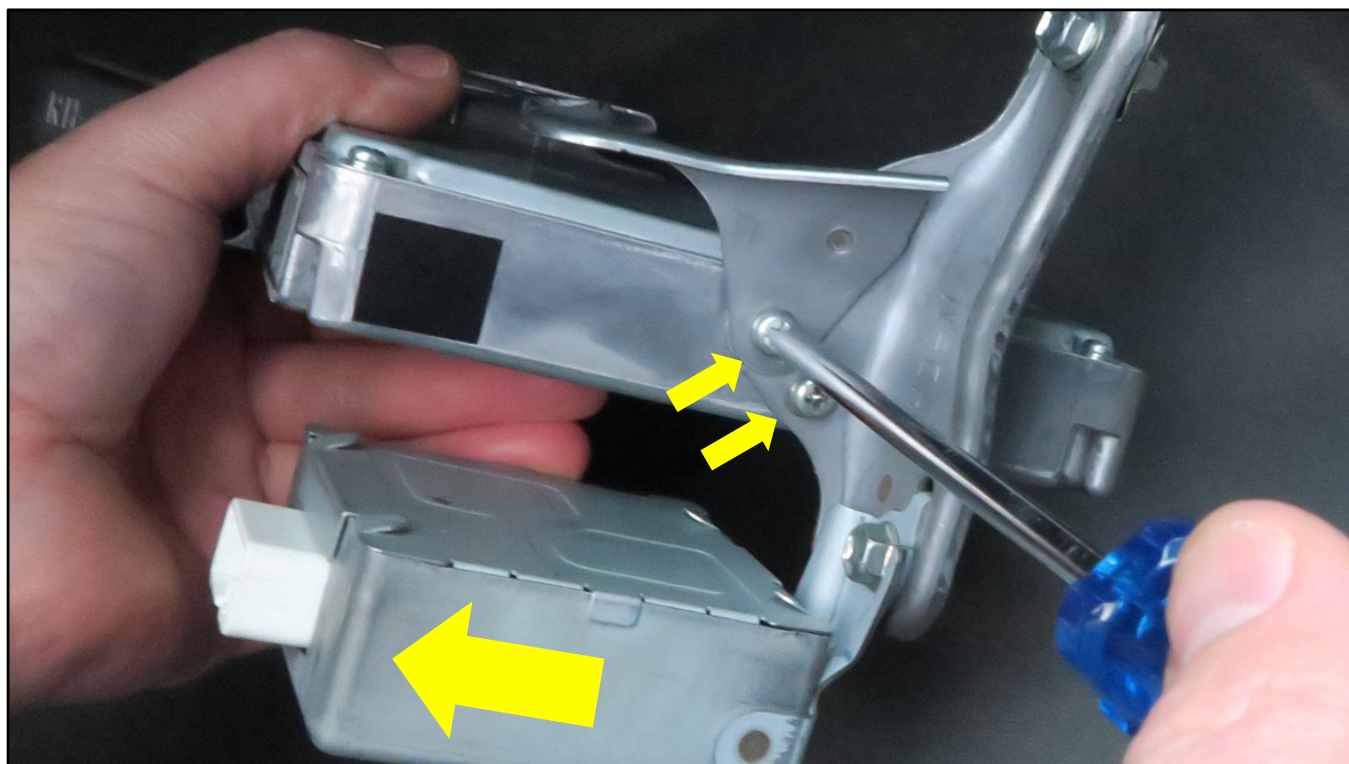
**Step 10:**

Remove two screws from the bracket. Remove one bolt and the Turbo Control ECU.

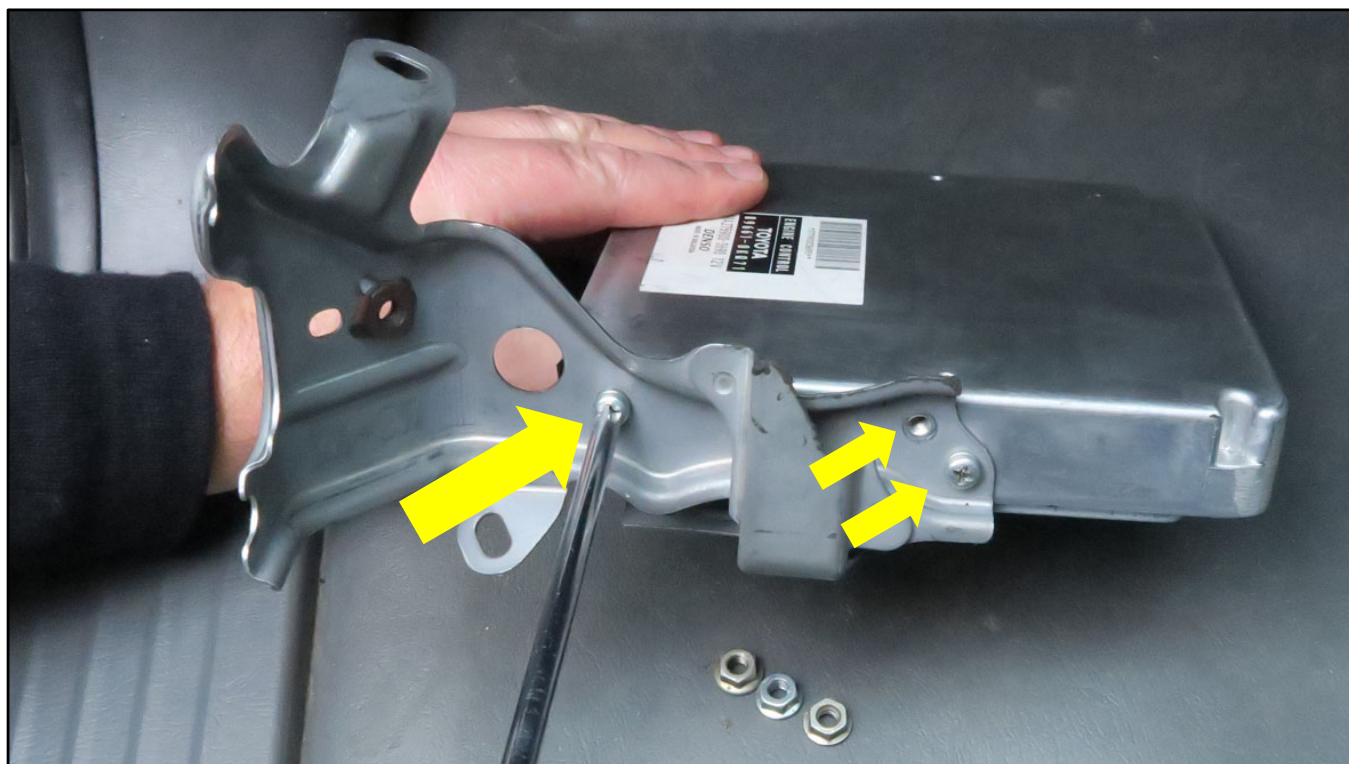

**Step 11:**

Remove three screws from the bracket.

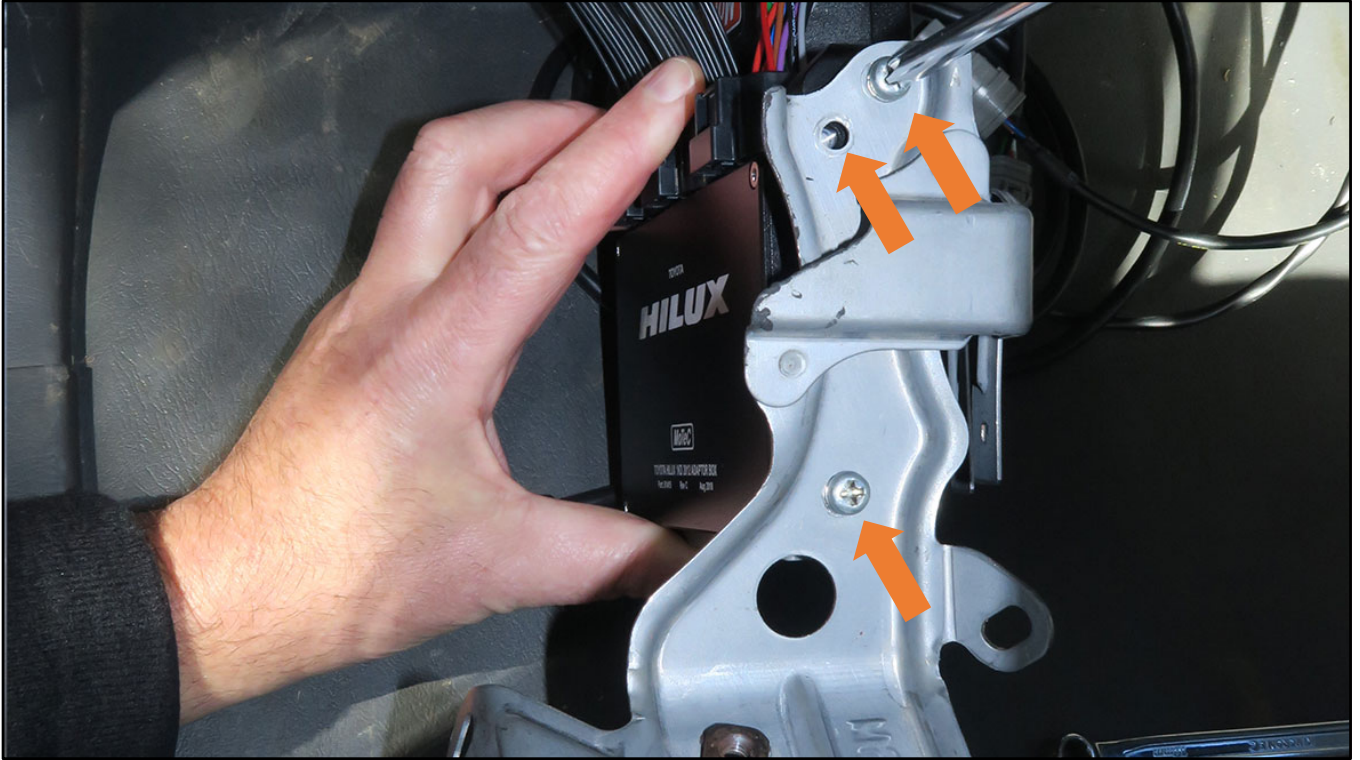
**Step 12:**

Attach the M1 Kit assembly to the bracket with three screws.



**Step 13:**

Attach the M1 Kit assembly to the bracket with two screws.

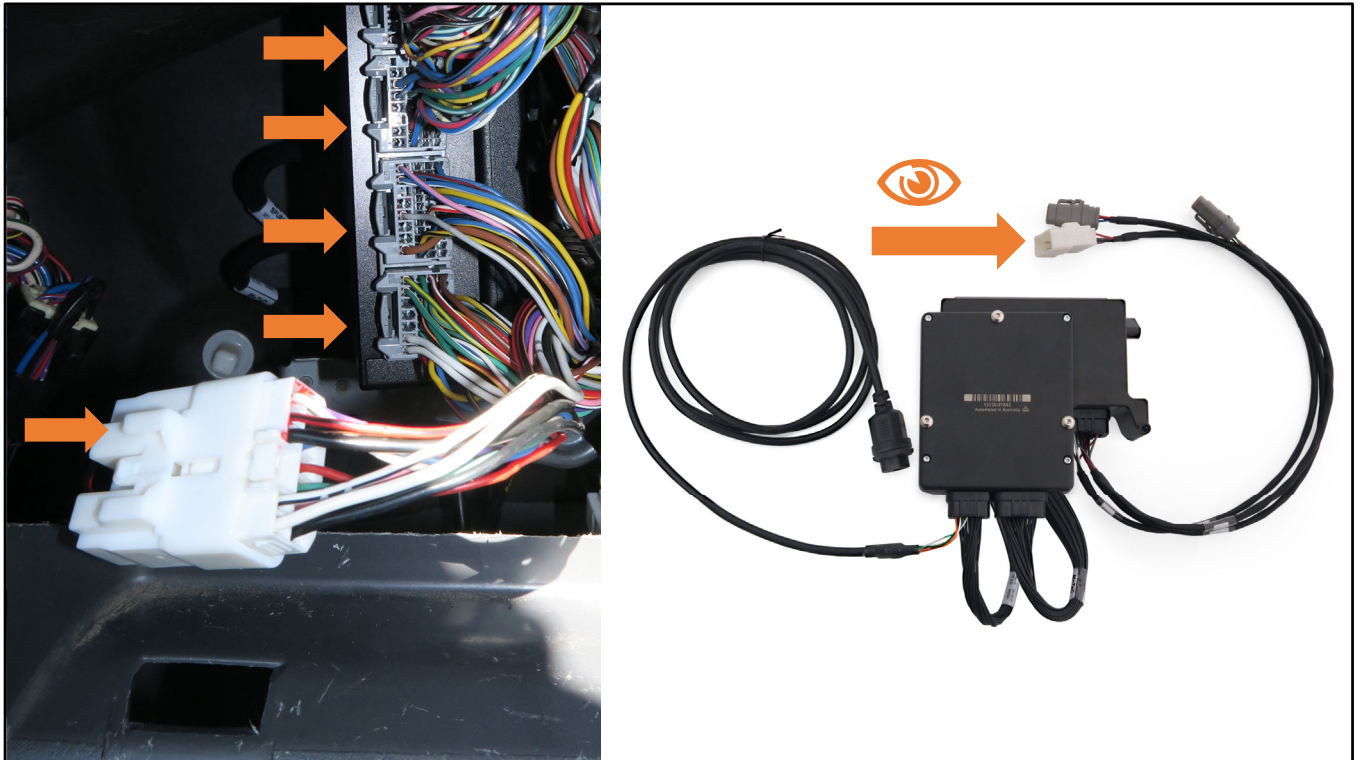
**MoTeC****Step 14:**

Manoeuvre the assembly into position, refit the bracket nuts and attach the five plugs.